

# two-in-one-

## MAXLUPE MINI PLUS

By connecting the receiver of **MAXLUPE MINI PLUS** to your television set, you achieve an even greater magnification. With the touch of one button, the image is transmitted wirelessly to the television screen.

**MAXLUPE MINI PLUS** is a mobile reading system and a CCTV at the same time.



Detailed product information is available from Reinecker Reha-Technik GmbH or your authorized distributor!

### Ihr Ansprechpartner



1808-G Janke Drive  
Northbrook, IL 60062  
1-800-468-4789  
[www.LSSproducts.com](http://www.LSSproducts.com)

Reinecker Reha-Technik GmbH  
Sandwiesenstrasse 19  
64665 Alsbach-Hähnlein  
GERMANY

Phone: +49 (0) 62 57/9 31 10  
Fax: +49 (0) 62 57/25 61

[info@reineckerreha.com](mailto:info@reineckerreha.com)  
[www.reineckerreha.com](http://www.reineckerreha.com)

## MAXLUPE MINI

Version 1.0, Stand 07/06, Art.-Nr.: 000 10 759



### More than just a magnifier!

an electronic magnifier that brings back the fun of reading

- **MAXLUPE MINI plus**
- **MAXLUPE MINI**

# Small... but great comfort

**MAXLUPE MINI** is the first magnifier that combines, in a compact casing, the ease of use and the design of a classical hand held magnifier with the comfort of a CCTV. As the handling is similar to that of ordinary optical magnifiers you don't need to acquire new reading techniques.

**MAXLUPE** finally permits to browse catalogues, read a good book or enjoy your holiday snapshots effortlessly. It has never been so easy. All you have to do is place your **MAXLUPE MINI** on the text or document you want to look at and select the magnification level best suited.

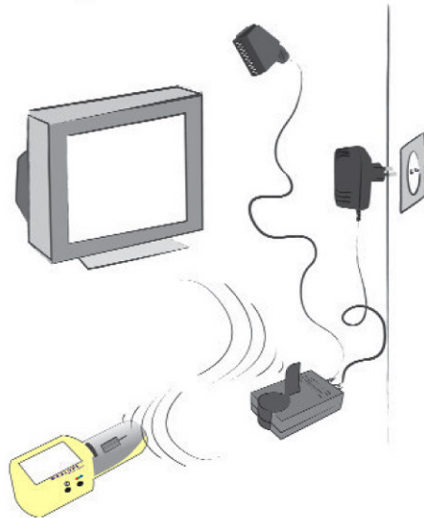

## Reading in a new dimension



**MAXLUPE MINI**



**MAXLUPE MINI PLUS**

I take my **MAXLUPE MINI** with me wherever I go!



With the integrated battery **MAXLUPE MINI** is your reliable companion for your travels, leisure or your job.

### Your advantages at one glance:

- Ease of use and flexibility
- Two magnification levels (x4 - x8) / connected to TV dependant on size of TV screen
- Various colour options
- Compact handle
- Ergonomic viewing angle
- Wireless transmission to your TV set (**MAXLUPE MINI PLUS**)



Choose among various colour options according to your own requirements